

Swing handle lock

A-1209

RL

IP65

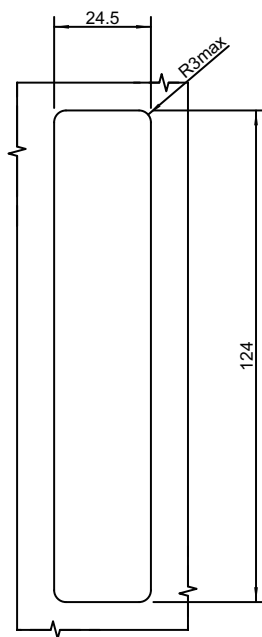
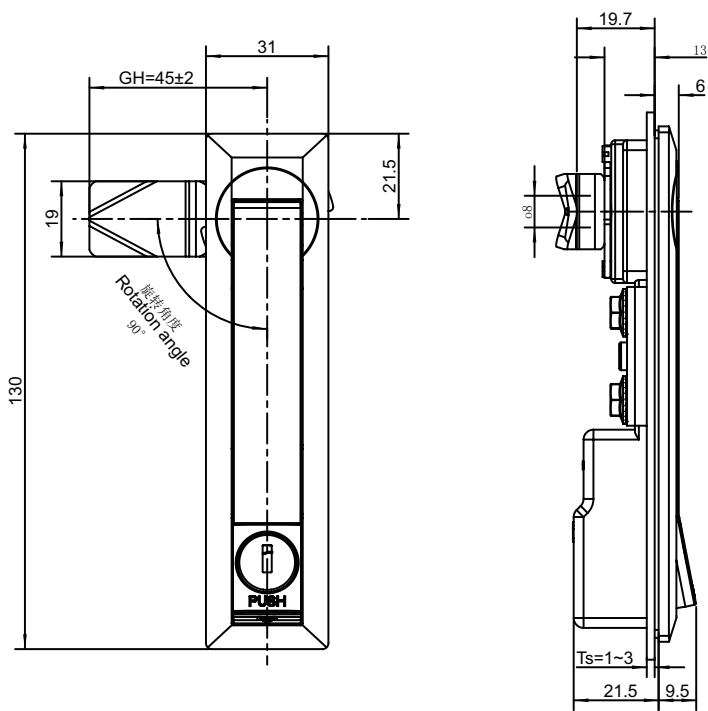

开孔尺寸
Cut out

如需获得产品3D模型图，请联系 WWW.FORND.COM

1. Material and surface treatment:
Lock body, handle, dust cover : Zamak
DIN-EN 1774-ZnAl4Cu1
Steel bolt: iron galvanized
Sealing ring: EPDM foam.

2. Performance parameters:
Protection class: IP65
Handle bearing tension value: ≤ 350N
Handle bearing torque value: ≤ 25N. m

3. Remark:
Padlockable on request
Default K333 key

1. 材质及表面处理:
锁体, 手柄, 防尘盖: 5# 锌合金喷塑黑
钢栓: 铁镀锌
密封圈: EPDM发泡胶。

2. 性能参数:
防护等级: IP65
手柄承载拉力值: ≤ 350N
手柄承载扭矩值: ≤ 25N.m

3. 备注:
可配挂锁
默认K333钥匙

Version A(锁舌型 Cam control)

亚光漆 Matt Pnish paint	喷塑亚光黑 Black powder coated
A-1209-1101-50	A-1209-1101-40