

Swing handle lock

**A-1204**



RL

IP65

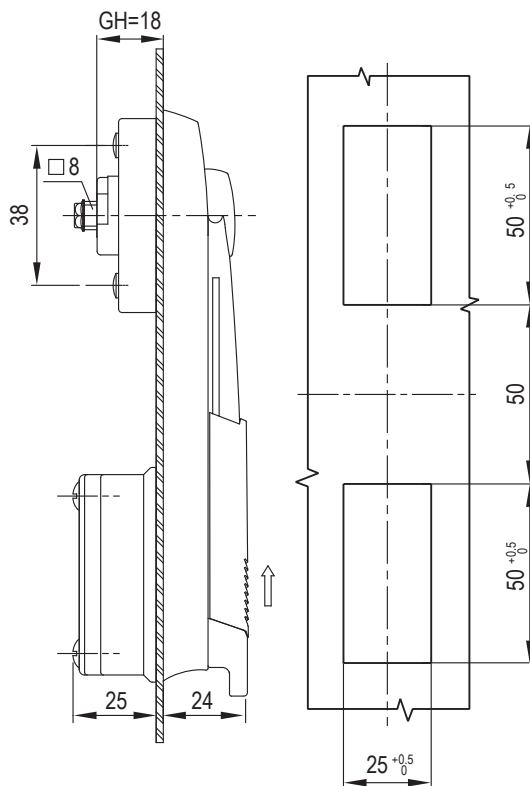
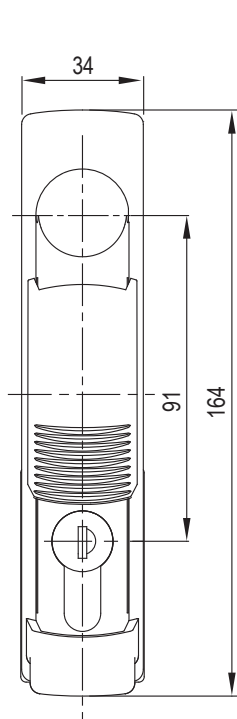

半圆柱 K333 相同钥匙  
Alike K333 Profile Round Cylinder

开孔尺寸  
Panel Cutout

如需获得产品3D模型图，请联系 WWW.FORND.COM

1. Material and surface treatment:  
Lock body, handle: PA66+30%GF  
Steel bolt: iron galvanized  
Sealing ring: EPDM foam.

2. Performance parameters:  
Protection class: IP65  
Handle bearing tension value:  $\leq 520\text{N}$   
Handle bearing torque value:  $\leq 27\text{N}\cdot\text{m}$   
Maximum static load: 270N

3. Remarks:  
Optional dedicated key  
CH751 key optional  
Default K333 key

1. 材质及表面处理:  
锁体, 手柄: PA66+30%GF  
钢栓: 铁镀锌  
密封圈: EPDM发泡胶。

2. 性能参数:  
防护等级: IP65  
手柄承载拉力值:  $\leq 520\text{N}$   
手柄承载扭矩值:  $\leq 27\text{N}\cdot\text{m}$   
最大静载荷: 270N

3. 备注:  
专用钥匙可选  
CH751 钥匙可选  
默认K333钥匙

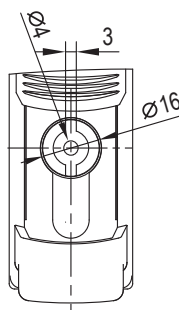

双翅 4mm  
Double Bit 4mm

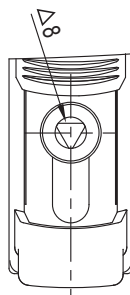

三角锁芯 8mm  
Triangular 8mm

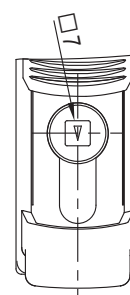

四方锁芯 7mm  
Square 7mm

锁芯 Cylinder style	VersionA( 锁舌型 Cam control)
	有防尘盖 With Dust Cap
半圆柱 K333 相同钥匙 Alike K333 Profile Round Cylinder	A-1204-1P01-60
双翅 4mm (Double Bit 4mm)	A-1204-1P02-60
四方锁芯 7mm (Square 7mm)	A-1204-1P03-60
三角锁芯 8mm (Triangular 8mm)	A-1204-1P04-60