

Swing handle lock

A-1201



RL

IP65

IP65

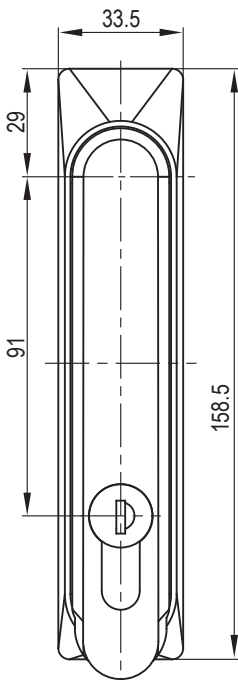

半圆柱 K333 相同钥匙
Alike K333 Prople Round Cylinder

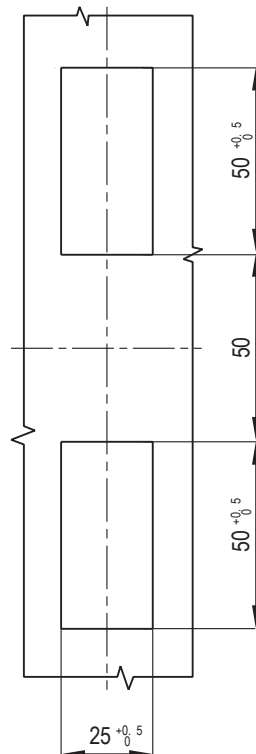
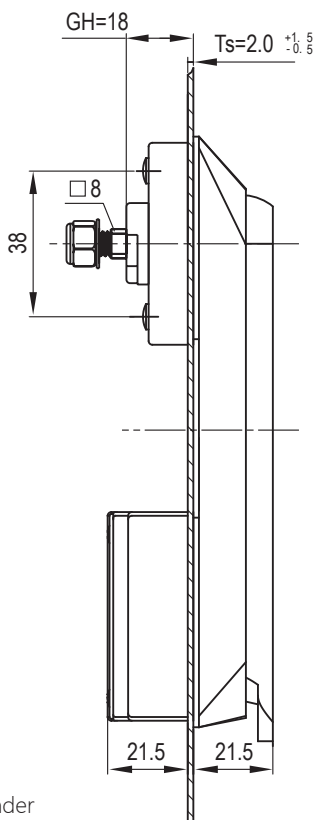
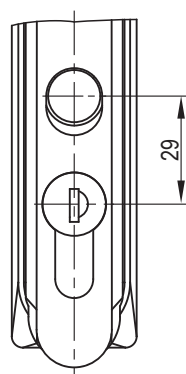

开孔尺寸
Panel Cutout

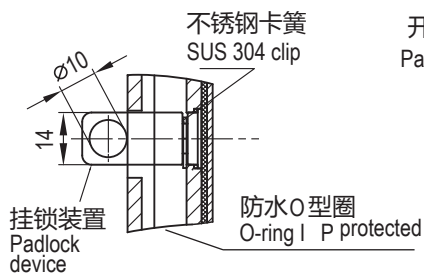

不锈钢卡簧
SUS 304 clip

挂锁装置
Padlock device

防水O型圈
O-ring I P protected

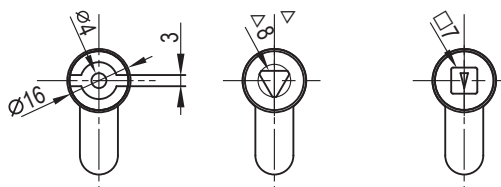

双翅 4m m
Double Bit 4mm

三角锁芯 8m m
Triangular 8mm

四方锁芯 7m m
Square 7mm

如需获得产品3D模型图，请联系 WWW.FORND.COM

1. Material and surface treatment:
Lock body, handle, dust cover : Zamak
DIN-EN 1774-ZnAl4Cu1
Steel bolt: iron galvanized
Sealing ring: EPDM foam.

2. Performance parameters:
Protection class: IP65
Handle bearing tension value: $\leq 400\text{N}$
Handle bearing torque value: $\leq 35\text{N}\cdot\text{m}$

4. Remarks:
Optional dedicated key
CH751 key optional
Can be equipped with stainless steel padlock
Default K333 key

1. 材质及表面处理:
锁体, 手柄, 防尘盖: 5#锌合金喷塑黑
钢栓: 铁镀锌
密封圈: EPDM发泡胶。

2. 性能参数:
防护等级: IP65
手柄承载拉力值: $\leq 400\text{N}$
手柄承载扭矩值: $\leq 35\text{N}\cdot\text{m}$

4. 备注:
专用钥匙可选
CH751 钥匙可选
可配不锈钢挂锁
默认 K333 钥匙

锁芯 Cylinder style	VersionA(锁舌型 Cam control)	
	有防尘盖 With Dust Cap	无防尘盖 Without Dust Cap
半圆柱 K333 相同钥匙 Alike K333 Prople Round Cylinder	A-1201-1P01-C-40	A-1201-1P01-NC-40
双翅 4mm (Double Bit 4mm)	A-1201-1P02-C-40	A-1201-1P02-NC-40
四方锁芯 7mm (Square 7mm)	A-1201-1P03-C-40	A-1201-1P03-NC-40
三角锁芯 8mm (Triangular 8mm)	A-1201-1P04-C-40	A-1201-1P04-NC-40