

A-1103

Swing handle lock

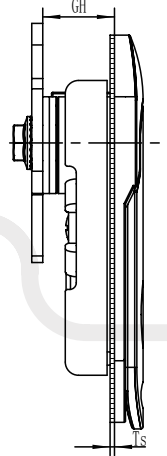
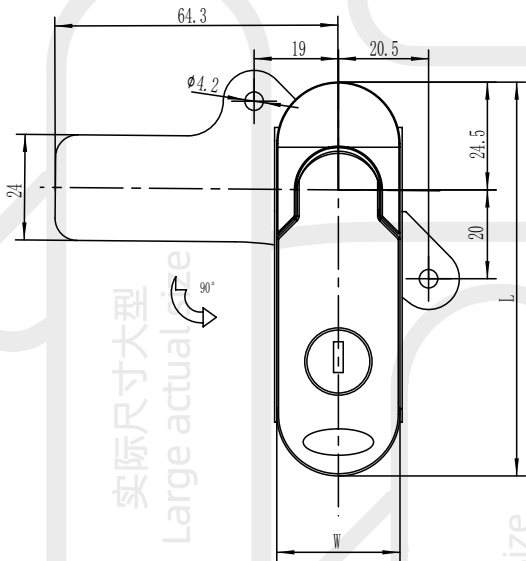

实际尺寸大型
Large actual size

实际尺寸中型
Medium actual size

实际尺寸小型
Small actual size

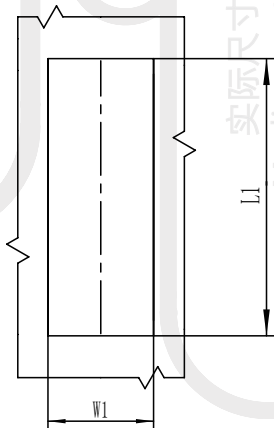

开孔尺寸
Panel Cutout

RL

SUS304 SERIES

IP65



尺寸 Size	L	W	L1	W1	GH
小型 Small	89mm	28mm	63mm	24mm	16mm
中型 Medium	107mm	28mm	80mm	24mm	16mm
大型 Large	123mm	28mm	97mm	24mm	16mm

1. Material and surface treatment:
Lock body, handle : Zamak DIN-EN 1774-ZnAl4Cu1 or SUS304
Steel bolt: iron galvanized or SUS304
Sealing ring: EPDM foam.
2. Performance parameters:
Protection class: IP65
Handle bearing tension value: $\leq 180N$
Handle bearing torque value: $\leq 14N \cdot m$
Maximum static load: 190N
3. Function Description:
Open the handle upwards and rotate it 90 degrees to achieve opening or closing.
Universal left and right locks.
4. Remarks:
Default key K200

1.材质及表面处理:
锁体, 手柄: 5#锌合金 或 SUS304
钢栓: 铁镀锌 或 SUS304
密封圈: EPDM发泡胶。

2.性能参数:
防护等级: IP65
手柄承载拉力值: $\leq 180N$
手柄承载扭矩值: $\leq 14N \cdot m$
最大静载荷: 190N

3.功能描述:
手柄向上打开, 旋转 90度, 实现打开或者关闭。左右锁通用。

4.备注:
默认钥匙 K200

尺寸 Size	锌合金 Zinc alloy		不锈钢 Stainless steel
	喷塑黑 Powder coating black	纳米喷漆 (银亚光) NM spray painting (matte silver)	拉丝抛光 polishing
小型 Small	A-1103-10-40	A-1103-10-50	A-1103-10-A1
中型 Medium	A-1103-20-40	A-1103-20-50	A-1103-20-A1
大型 Large	A-1103-30-40	A-1103-30-50	A-1103-30-A1